

Hamal

Community Development District

Agenda

Wednesday
January 20, 2010
8:30 a.m.

Briar Bay Clubhouse
3400 Celebration Blvd.
West Palm Beach, FL 33411

1. Roll Call
2. Approval of the Minutes of the October 21, 2009 Meeting
3. Ratification of Proposals for Fountains Project as discussed and approved at the October 21, 2009 meeting
4. Ratification of Agreement with Static Electric Company for Electrical Work
5. Staff Reports
 - A. Attorney
 - B. Engineer
 - C. Field Operations - Discussion of Letter from Homeowner
 - D. Manager
6. Supervisors Requests and Audience Comments
7. Financial Reports
 - A. Approval of Check Register
 - B. Balance Sheet and Income Statement
8. Adjournment

AFTER RECORDING - RETURN TO:

Reggin McDermott
Static Electric Company
1456-A Skees Road
West Palm Beach, FL 33411
561-684-6100



PERMIT NUMBER:

NOTICE OF COMMENCEMENT

The undersigned hereby given notice that improvement will be made to certain real property, and in accordance with Chapter 713, Florida Statutes the following information is provided in the Notice of Commencement.

1. DESCRIPTION OF PROPERTY - unaddressed right of way buffer parcel

TAX FOLIO NUMBER: 74-42-43-15-03-018-0000

SUBDIVISION: Hamilton Bay TR R K/A Private Street **BLOCK** _____ **TRACT** _____ **LOT** _____ **BLDG** _____ **UNIT** _____

2. GENERAL DESCRIPTION OF IMPROVEMENT: Labor and materials to supply power street lights

3. OWNER INFORMATION: a. Name: Hamal Bay Community Assn Inc.

b. Address 13682 Sand Ridge Road, Palm Beach Gardens, FL 33418-8639

c. Interest in property: Fee Simple

d. Name and address of fee simple titleholder (if other than Owner) _____

4. CONTRACTOR'S NAME, ADDRESS AND PHONE NUMBER:

Static Electric Company, 1456-A Skees Road, West Palm Beach, FL 33411

Phone: (561)684-6100

5. SURETY'S NAME, ADDRESS AND PHONE NUMBER AND BOND AMOUNT:

N/A

6. LENDER'S NAME, ADDRESS AND PHONE NUMBER:

N/A

7. Persons within the State of Florida designated by Owner upon whom notices or other documents may be served as provided by Section 713.13 (1) (a) 7. Florida Statutes:

NAME, ADDRESS AND PHONE NUMBER:

N/A

8. In addition to himself or herself, Owner designates the following to receive a copy of the Lienor's Notice as provided in Section 713.13 (1) (b). Florida Statutes:

NAME, ADDRESS AND PHONE NUMBER:

N/A

9. Expiration date of notice of commencement (the expiration date is 1 year from the date of recording unless a different date is specified): _____, _____, 20__

WARNING TO OWNER: ANY PAYMENTS MADE BY THE OWNER AFTER THE EXPIRATION OF THE NOTICE OF COMMENCEMENT ARE CONSIDERED IMPROPER PAYMENTS UNDER CHAPTER 713, PART I, SECTION 713.13, FLORIDA STATUTES, AND CAN RESULT IN YOUR PAYING TWICE FOR IMPROVEMENTS TO YOUR PROPERTY. A NOTICE OF COMMENCEMENT MUST BE RECORDED AND POSTED ON THE JOB SITE BEFORE THE FIRST INSPECTION. IF YOU INTEND TO OBTAIN FINANCING, CONSULT WITH YOUR LENDER OR AN ATTORNEY BEFORE COMMENCING WORK OR RECORDING YOUR NOTICE OF COMMENCEMENT.

XX Charles Collazzo
Signature of Owner or
Owner's Authorized Officer/Director/Partner/Manager

X Charles Collazzo
Print Name and Provide Signatory's Title/Office
Chairman, Hamal CDD

State of Florida
County of Palm Beach

Hamal CDD
7 Fountains Project
Approved 10/21/09

Vendor	Total	Deposit at Signing	Upon Substantial Completion	Final Completion
Fountain Design Group, Inc.	\$16,500.00	\$58,250.00	0	\$58,250.00
SEC - Lake 1	\$9,957.00	\$2,348.75	\$4,697.50	\$2,348.75
SEC - Lake 2	\$11,765.00	\$2,941.25	\$5,882.50	\$2,941.25
SEC - Lake 4	\$8,720.00	\$2,180.00	\$4,360.00	\$2,180.00
SEC - Lake 6	\$10,950.00	\$2,737.50	\$5,475.00	\$2,737.50
SEC - Lake 7	\$15,015.00	\$3,753.75	\$7,507.50	\$3,753.75
SEC - Lake 8	\$10,980.00	\$2,745.00	\$5,490.00	\$2,745.00
SEC - Lake 9	\$16,957.00	\$4,239.25	\$8,478.50	\$4,239.25
	\$200,282.00	\$79,195.50	\$41,891.00	\$79,195.50

770.558.490

FOUNTAIN DESIGN GROUP, INC.

7628 NW 6TH AVENUE BOCA RATON, FL 33487
561-994-3939 1-800-446-1537 FAX 561-994-3944

CONTRACT

**TO: HAMAL CDD
3568 TURTLE ISLAND COURT
WEST PALM BEACH, FL. 33411**

ATTN: JEFFREY HERMAN

FROM: STEVEN R. JOHNSON

DATE: OCTOBER 21, 2009

EQUIPMENT FURNISHED: SEE ATTACHED SPECS

SCOPE OF WORK:

- 1) CASCADE FOUNTAINS, A DIVISION OF **FOUNTAIN DESIGN GROUP, INC.**, SHALL DELIVER THE FOLLOWING FLOATING FOUNTAINS AND FLOAT THE FOUNTAINS INTO POSITION IN THE LAKE; AND PROPERLY MOOR THEM.
 - *(1) ONE LIBRA 1000**, 10HP WITH 250' OF POWER CABLES & SIX (6) 500 WATT LIGHTS AND WITH EIGHT (8) JETS .
 - *(5) ONE LIBRA 1000's**, 10HP WITH 250' OF POWER CABLES & SIX (6) 500 WATT LIGHTS
 - *(1) ONE STARBURST 1000**, 10HP WITH 250' OF POWER CABLES & SIX 500 WATT LIGHTS
 - **voltage and phase to be determined**
- 2) CASCADE FOUNTAINS SHALL PROVIDE YOUR ELECTRICIAN WITH THE STAINLESS STEEL CONTROL PANELS.
- 3) YOUR ELECTRICIAN SHALL SET THE PANELS; HOT WIRE WITH PROPER WIRE SIZE; AND PROVIDE 2" CONDUITS TO THE LAKE EDGE, PER FOUNTAIN.
- 4) CASCADE FOUNTAINS SHALL RUN THE ELECTRICAL CABLES FROM THE FOUNTAINS TO THE PANEL.
- 5) CASCADE FOUNTAINS SHALL MAKE ANY ADJUSTMENTS TO THE FOUNTAIN DISPLAY, IF NECESSARY, UPON START-UP.

PAGE TWO:
RE: HCDD

PRICE:

(1) ONE LIBRA 1000 W/ 8 JETS	\$16,500.00
(5) FIVE LIBRA 1000 @ \$16,500.00 EACH	TOTAL \$82,500.00
(1) ONE STARBURST 1000	<u>\$17,500.00</u>
TOTAL COST FOR THE 7 NEW LAKE FOUNTAINS	\$116,500.00

TERMS:

- 1) A 50% DEPOSIT IS DUE AT SIGNING WITH THE REMAINING BALANCE DUE UPON DELIVERY.
- 2) ANY AND ALL PERMITS THAT MAY BE REQUIRED BY ANY AGENCY SHALL BE THE PURCHASER'S RESPONSIBILITY.

WARRANTY:

ONE (1) YEAR LIMITED WARRANTY ON FOUNTAIN COMPONENTS, INCLUDING LABOR. LIGHT BULBS AND BULB CHANGE OUTS ARE NOT INCLUDED IN THIS WARRANTY.

A THREE-YEAR (3) LIMITED WARRANTY ON FOUNTAIN COMPONENTS, INCLUDING LABOR, IS AVAILABLE, BASED ON ACCEPTANCE OF OUR QUARTERLY MAINTENANCE CONTRACT.

THIS PROPOSAL IS RESPECTFULLY SUBMITTED BY:

FOUNTAIN DESIGN GROUP, INC., dba, CASCADE FOUNTAINS

BY:  DATE: 10/23/09

THE PRICES, SPECIFICATIONS AND CONDITIONS ARE HEREBY ACCEPTED. YOU ARE AUTHORIZED TO DO THE WORK AS SPECIFIED. PAYMENT WILL BE MADE AS OUTLINED WITHIN THIS PROPOSAL.

ACCEPTED:

BY:  DATE: 10/29/09

Chairman, Hamal CDD

FOUNTAIN DESIGN GROUP, INC.

CASCADE FOUNTAINS FOUNTAIN SERVICES COASTAL CONTROLS

7628 NORTHWEST 6TH AVENUE, BOCA RATON, FL 33487
561-994-3939 1-800-446-1537 FAX 561-994-3944

MAINTENANCE CONTRACT/PROPOSAL

**TO: HAMAL CDD
3568 TURTLE ISLAND COURT
WEST PALM BEACH, FL. 33411**

ATTN: JEFFERY HERMAN

FROM: STEVEN R. JOHNSON

DATE: OCTOBER 21, 2009

SCOPE OF WORK:

FOUNTAIN SERVICES, A DIVISION OF FOUNTAIN DESIGN GROUP INC., WILL PERFORM THE FOLLOWING QUARTERLY CLEANING ON THE (9) NINE FLOATING FOUNTAINS, AT THE ABOVE PROPERTY, PER THE CHECK LIST BELOW:

1. CHECK CONTROL PANEL COMPONENTS AND AMPERAGE DRAW OF PUMP MOTORS, INCLUDING TIMERS
2. CLEAN JUNCTION INTAKE SCREENS
3. CLEAN AND ADJUST WATER FEATURE JETS
4. CLEAN AND CHECK LIGHTS FOR BURNED OUT LAMPS AND DAMAGED CORDS
5. REPLACE ANY LAMPS AS NEEDED FOR PURCHASE PRICE OF BULB*
6. CHECK FOR POWER SURGES AND RESET G.F.C.I. BREAKERS
7. VISUALLY CHECK ALL ACCESSIBLE PIPING SYSTEMS FOR DAMAGE AND WATER LEAKS

THIS IS A CLEANING CONTRACT AND ANY OTHER REPAIRS OR ADDITIONAL SERVICES THAT MAY BE REQUIRED, OTHER THAN THE SERVICES LISTED ABOVE SHALL CHARGED AT A RATE OF 95.00 FOR THE FIRST HALF HOUR AND 75.00 PER HOUR THEREAFTER, PLUS PARTS. A QUOTE WILL BE SENT IF THESE REPAIRS EXCEED 300.00.

*THE COST OF LIGHT BULBS IS AN ADDITIONAL CHARGE.

PAGE TWO
RE: HAMAL CCD

MAINTENANCE CONTRACT

TERMS:

FOUR QUARTERLY PAYMENTS OF \$675.00 PAYABLE UPON RECEIPT OF INVOICE TO FOUNTAIN DESIGN GROUP, INC.

EITHER PARTY MAY CANCEL THIS AGREEMENT WITH A 30-DAY NOTICE.

THIS PROPOSAL IS RESPECTFULLY SUBMITTED BY:

FOUNTAIN DESIGN GROUP, INC., dba, FOUNTAIN SERVICES

BY:  DATE: 10/23/09

THIS PROPOSAL ACCEPTED BY:

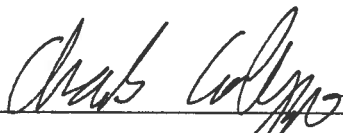
 DATE: 10/29/09
Chairman, Hamal CCD



Static Electric Company

1456-A Skees Road, West Palm Beach, FL 33411
Phone: 561-684-6100 * Fax: 561-684-6175

Confidential Proposal

Date: October 14, 2009

To: Hamal Community Development District
Attn: Jeffrey Herman

Phone: 561-681-9502
Fax: 561-683-1949

Project Hamilton Bay Fountain Power
Lake #1

Location: West Palm Beach, FL.

Date of Plans: None

Architect: N/A

Pages:

Addenda: None

We submit the following proposal to you in confidence, not to be disclosed to any other person without our prior written consent, to perform electrical work as shown in the following scope of work and specifications:

As per Plans and Specifications. Includes but not limited to the following:

SCOPE OF WORK INCLUDES:

1. Supply and install (1) equipment rack containing, (1) 100 amp meter socket, (1) 60 amp, 240 volt disconnect. Wire the new meter and disconnect from the local FPL transformer within 15 feet.
2. Provide (1) underground pvc junction box and (1) brooks box for connection of pump and light feeds to fountain control cable.
3. Provide (1) 1 1/2" underground PVC conduit from fountain controller (supplied by others). Provide (3) # 8 and 2# 10 conductors approximately 130' to the edge of the lake for the feeders for the fountain control splice box.
4. Provide (1) 2" sch 80 underground PVC conduit from the fountain control splice box extending 10 feet in to the lake. Connection by others of the 2,500 watt load of fountain lighting and 50 amp load for the 10 HP pump control cable.
5. Provide (1) 2" empty underground PVC conduit for fountain cable by others.
6. Permits, engineering, inspections.

EXCLUDES:

- Survey
- Connections to fountain or controllers.
- FPL fees

TOTAL AMOUNT THIS PROPOSAL, \$9,395.00

Static Electric Company

2

NINE THOUSAND, THREE HUNDRED AND NINETY FIVE DOLLARS.

Payment terms:

25% down payment

50% upon substantial completion

25% upon final completion.

Contract terms:

Upon acceptance of this proposal, customer shall execute contract with Static Electric Company within 5 working days otherwise proposal may be withdrawn.

THIS PROPOSAL IS ONLY VALID FOR (15) DAYS DUE TO THE CONTINUALLY RISING MATERIAL COST.

Submitted by:



Anthony J. Maturo, President
Static Electric Company

As authorized representative for the above, I Charles Collazzo hereby approve the above proposal pending executed contract.

Charles Collazzo
~~Hamilton Bay Condo Assoc~~
Chairman, Hamal CDD

Date: 10/29/09



Static Electric Company

1456-A Skees Road, West Palm Beach, FL 33411
Phone: 561-684-6100 * Fax: 561-684-6175

Confidential Proposal

Date: October 15, 2009

To: Hamal Community Development District
Attn: Jeffrey Herman

Phone: 561-681-9502
Fax: 561-683-1949

Project Hamilton Bay Fountain Power
Lake #2

Location: West Palm Beach, FL.

Date of Plans: None

Architect: N/A

Pages:

Addenda: None

We submit the following proposal to you in confidence, not to be disclosed to any other person without our prior written consent, to perform electrical work as shown in the following scope of work and specifications:

As per Plans and Specifications. Includes but not limited to the following:

SCOPE OF WORK INCLUDES:

1. Supply and install (1) equipment rack containing, (1) 100 amp meter socket, (1) 60 amp, 240 volt disconnect.
2. Directional boar underneath Hamilton Key Road.
3. Provide (1) 1 1/2" underground PVC conduit and wire the new meter and disconnect with (3) #1 THHN conductors from the local FPL transformer to the equipment rack (approximately 350 feet).
4. Provide (1) 2" sch 80 underground PVC conduit from the fountain controller (furnished by others) extending 10 feet in to the lake. Connection by others of the 2,500 watt load of fountain lighting and 50 amp load for the 10 HP pump control cable.
5. Permits, engineering, inspections.

EXCLUDES:

- Survey
- Connections to fountain or controllers.
- FPL fees

TOTAL AMOUNT THIS PROPOSAL, \$11,765.00

ELEVEN THOUSAND, SEVEN HUNDRED AND SIXTY FIVE DOLLARS.

Static Electric Company

2

Payment terms:

25% down payment
50% upon substantial completion
25% upon final completion.

Contract terms:

Upon acceptance of this proposal, customer shall execute contract with Static Electric Company within 5 working days otherwise proposal may be withdrawn.

THIS PROPOSAL IS ONLY VALID FOR (15) DAYS DUE TO THE CONTINUALLY RISING MATERIAL COST.

Submitted by: 

Anthony J. Maturo, President
Static Electric Company

As authorized representative for the above, I Charles Collazzo hereby approve the above proposal pending executed contract.

Hamilton Bay Condo Assoc

Chairman, Hamal CDD

Date: 10/29/09



Static Electric Company

1456-A Skees Road, West Palm Beach, FL 33411
Phone: 561-684-6100 * Fax: 561-684-6175

Confidential Proposal

Date: October 15, 2009

To: Hamal Community Development District
Attn: Jeffrey Herman

Phone: 561-681-9502
Fax: 561-683-1949

Project Hamilton Bay Fountain Power
Lake #4

Location: West Palm Beach, FL.

Date of Plans: None

Architect: N/A

Pages:

Addenda: None

We submit the following proposal to you in confidence, not to be disclosed to any other person without our prior written consent, to perform electrical work as shown in the following scope of work and specifications:

As per Plans and Specifications. Includes but not limited to the following:

SCOPE OF WORK INCLUDES:

1. Supply and install (1) equipment rack containing, (1) 100 amp meter socket, (1) 60 amp, 240 volt disconnect.
2. Provide (1) 1" underground PVC conduit and wire the new meter and disconnect with (3) #3 THHN conductors from the local FPL transformer to the equipment rack (approximately 35 feet).
3. Provide (1) 2" sch 80 underground PVC conduit from the fountain controller (furnished by others) extending 10 feet in to the lake. Connection by others of the 2,500 watt load of fountain lighting and 40 amp load for the 7.5 HP pump control cable.
4. Permits, engineering, inspections.

EXCLUDES:

- Survey
- Connections to fountain or controllers.
- FPL fees

TOTAL AMOUNT THIS PROPOSAL, \$8,720.00

EIGHT THOUSAND, SEVEN HUNDRED AND TWENTY DOLLARS.

Static Electric Company

2

Payment terms:

25% down payment

50% upon substantial completion

25% upon final completion.

Contract terms:

Upon acceptance of this proposal, customer shall execute contract with Static Electric Company within 5 working days otherwise proposal may be withdrawn.

THIS PROPOSAL IS ONLY VALID FOR (15) DAYS DUE TO THE CONTINUALLY RISING MATERIAL COST.

Submitted by:

Anthony J. Maturo, President
Static Electric Company

As authorized representative for the above, I Charles Collazzo hereby approve the above proposal pending executed contract.

Charles Collazzo
~~Hamilton Bay Gendo Assoc~~
Chairman, Hamal CDD

Date: 10/29/09



Static Electric Company

1456-A Skees Road, West Palm Beach, FL 33411
Phone: 561-684-6100 * Fax: 561-684-6175

Confidential Proposal

Date: October 15, 2009

To: Hamal Community Development District
Attn: Jeffrey Herman

Phone: 561-681-9502
Fax: 561-683-1949

Project Hamilton Bay Fountain Power
Lake #6

Location: West Palm Beach, FL.

Date of Plans: None

Architect: N/A

Pages:

Addenda: None

We submit the following proposal to you in confidence, not to be disclosed to any other person without our prior written consent, to perform electrical work as shown in the following scope of work and specifications:

As per Plans and Specifications. Includes but not limited to the following:

SCOPE OF WORK INCLUDES:

1. Supply and install (1) equipment rack containing, (1) 100 amp meter socket, (1) 60 amp, 240 volt disconnect. Wire the new meter and disconnect from the local FPL transformer within 25 feet.
2. Provide (1) underground pvc junction box and (1) brooks box for connection of pump and light feeds to fountain control cable.
3. Provide (1) 1 1/2" underground PVC conduit from fountain controller (supplied by others). Provide (3) # 3 and (2) # 4 conductors approximately 325' to the edge of the lake for the feeders for the fountain control splice box.
4. Provide (1) 2" sch 80 underground PVC conduit from the fountain control splice box extending 10 feet in to the lake. Connection by others of the 2,500 watt load of fountain lighting and 50 amp load for the 10 HP pump control cable.
5. Permits, engineering, inspections.

EXCLUDES:

- Survey
- Connections to fountain or controllers.
- FPL fees

TOTAL AMOUNT THIS PROPOSAL, \$10,950.00
TEN THOUSAND, NINE HUNDRED AND FIFTY DOLLARS.

Static Electric Company

2

Payment terms:

25% down payment
50% upon substantial completion
25% upon final completion.

Contract terms:

Upon acceptance of this proposal, customer shall execute contract with Static Electric Company within 5 working days otherwise proposal may be withdrawn.

THIS PROPOSAL IS ONLY VALID FOR (15) DAYS DUE TO THE CONTINUALLY RISING MATERIAL COST.

Submitted by:



Anthony J. Maturo, President
Static Electric Company

As authorized representative for the above, I Charles Collazzo hereby approve the above proposal pending executed contract.

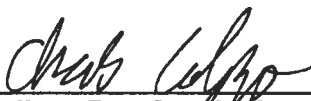
Hamilton Bay Geopls Assoc
Chairman, Hamal CDD

Date: 10/29/09



Static Electric Company

1456-A Skees Road, West Palm Beach, FL 33411
Phone: 561-684-6100 * Fax: 561-684-6175

Confidential Proposal

Date: October 15, 2009

To: Hamal Community Development District
Attn: Jeffrey Herman

Phone: 561-681-9502
Fax: 561-683-1949

Project Hamilton Bay Fountain Power
Lake #7

Location: West Palm Beach, FL.

Date of Plans: None

Architect: N/A

Pages:

Addenda: None

We submit the following proposal to you in confidence, not to be disclosed to any other person without our prior written consent, to perform electrical work as shown in the following scope of work and specifications:

As per Plans and Specifications. Includes but not limited to the following:

SCOPE OF WORK INCLUDES:

1. Supply and install (1) equipment rack containing, (1) 100 amp meter socket, (1) 60 amp, 240 volt disconnect. Wire the new meter and disconnect from the local FPL transformer within 250 feet.
2. Directional boar 100 feet underneath Celebration Street.
3. Provide (1) underground pvc junction box and (1) brooks box for connection of pump and light feeds to fountain control cable.
4. Provide (1) 1 1/2" underground PVC conduit from fountain controller (supplied by others). Provide (3) # 3 and (2) # 4 conductors approximately 300' to the edge of the lake for feeders to the fountain control underground splice box.
5. Provide (1) empty 2" sch 80 underground PVC conduit from the fountain control splice box extending 10 feet in to the lake. Connection of the 2,500 watt load of fountain lighting and 50 amp load for the 10 HP pump cable is by others.
6. Permits, engineering, inspections.

EXCLUDES:

- Survey
- Connections to fountain or controllers.
- FPL fees

TOTAL AMOUNT THIS PROPOSAL, \$15,015.00

Static Electric Company

2

FIFTEEN THOUSAND, AND FIFTEEN DOLLARS.

Payment terms:

25% down payment

50% upon substantial completion

25% upon final completion.

Contract terms:

Upon acceptance of this proposal, customer shall execute contract with Static Electric Company within 5 working days otherwise proposal may be withdrawn.

THIS PROPOSAL IS ONLY VALID FOR (15) DAYS DUE TO THE CONTINUALLY RISING MATERIAL COST.

Submitted by: 

Anthony J. Maturo, President
Static Electric Company

As authorized representative for the above, I Charles Collazzo hereby approve the above proposal pending executed contract.

Date: 10/29/09

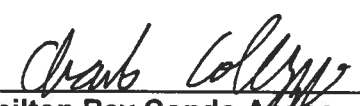
~~Hamilton Bay Condo Assoc~~
Chairman, Hamal CDD



Static Electric Company

1456-A Skees Road, West Palm Beach, FL 33411
Phone: 561-684-6100 * Fax: 561-684-6175

Confidential Proposal

Date: October 15, 2009

To: Hamal Community Development District
Attn: Jeffrey Herman

Phone: 561-681-9502
Fax: 561-683-1949

Project Hamilton Bay Fountain Power
Lake #8

Location: West Palm Beach, FL.

Date of Plans: None

Architect: N/A

Pages:

Addenda: None

We submit the following proposal to you in confidence, not to be disclosed to any other person without our prior written consent, to perform electrical work as shown in the following scope of work and specifications:

As per Plans and Specifications. Includes but not limited to the following:

SCOPE OF WORK INCLUDES:

1. Supply and install (1) equipment rack containing, (1) 100 amp meter socket, (1) 60 amp, 240 volt disconnect. Wire the new meter and disconnect from the local FPL transformer within 150 feet.
2. Provide (1) underground pvc junction box and (1) brooks box for connection of pump and light feeds to fountain control cable.
3. Provide (1) 1 1/2" underground PVC conduit from fountain controller (supplied by others). Provide (3) # 4 and (2) # 6 conductors approximately 225' to the edge of the lake for the feeds to the fountain control splice box.
4. Provide (1) empty 2" sch 80 underground PVC conduit from the fountain control splice box extending 10 feet in to the lake. Connection of the 2,500 watts of fountain lighting and 50 amp load for the 10 HP pump is by others.
5. Permits, engineering, inspections.

EXCLUDES:

- Survey
- Connections to fountain or controllers.
- FPL fees

TOTAL AMOUNT THIS PROPOSAL, \$10,980.00

Static Electric Company

2

TEN THOUSAND, NINE HUNDRED AND EIGHTY DOLLARS.

Payment terms:

25% down payment
50% upon substantial completion
25% upon final completion.

Contract terms:

Upon acceptance of this proposal, customer shall execute contract with Static Electric Company within 5 working days otherwise proposal may be withdrawn.

THIS PROPOSAL IS ONLY VALID FOR (15) DAYS DUE TO THE CONTINUALLY RISING MATERIAL COST.

Submitted by:

Anthony J. Maturo, President
Static Electric Company

As authorized representative for the above, I Charles Collazzo hereby approve the above proposal pending executed contract.

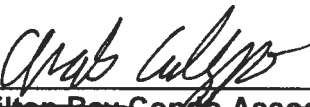
~~Hamilton Bay Group Assoc~~
Chairman, Hamat CDD

Date: 10/29/09



Static Electric Company

1456-A Skees Road, West Palm Beach, FL 33411
Phone: 561-684-6100 * Fax: 561-684-6175

Confidential Proposal

Date: September 18, 2009

To: Hamal Community Development District
Attn: Jeffrey Herman

Phone: 561-681-9502
Fax: 561-683-1949

Project Hamilton Bay Fountain Power
Lake #9

Location: West Palm Beach, FL.

Date of Plans: None

Architect: N/A

Pages:

Addenda: None

We submit the following proposal to you in confidence, not to be disclosed to any other person without our prior written consent, to perform electrical work as shown in the following scope of work and specifications:

As per Plans and Specifications. Includes but not limited to the following:

SCOPE OF WORK INCLUDES:

1. Supply and install (1) equipment rack containing, (1) 100 amp 3 phase meter socket, (1) 60 amp, 3 phase 240 volt disconnect.
2. Provide (1) 2" underground PVC conduit and wire the new meter and disconnect with (4) 2/0 THHN conductors from the local 3 phase FPL transformer to the equipment rack (approximately 900 feet).
3. Provide (1) 2" sch 80 underground PVC conduit from the fountain controller (furnished by others) extending 10 feet in to the lake. Connection by others of the 2,500 watt load of fountain lighting and 28.4 amp load for the 3 phase 10 HP pump control cable.
4. Permits, engineering, inspections.

EXCLUDES:

- Survey
- Connections to fountain or controllers.
- FPL fees

TOTAL AMOUNT THIS PROPOSAL, \$16,957.00

SIXTEEN THOUSAND, NINE HUNDRED AND FIFTY SEVEN DOLLARS.

Payment terms:

25% down payment
50% upon substantial completion
25% upon final completion.

Contract terms:

Upon acceptance of this proposal, customer shall execute contract with Static Electric Company within 5 working days otherwise proposal may be withdrawn.

THIS PROPOSAL IS ONLY VALID FOR (15) DAYS DUE TO THE CONTINUALLY RISING MATERIAL COST.

Submitted by:



Anthony J. Maturo, President
Static Electric Company

As authorized representative for the above, I

Charles Collazzo

hereby approve the above proposal pending executed contract.



~~Hamilton Bay Condo Assoc~~

Chairman, Hamal CDD

Date:

10/29/09



Static Electric Company

1456-A Skees Road, West Palm Beach, FL 33411
Phone: 561-684-6100 * Fax: 561-684-6175

Contract

Date: December 2, 2009

To: Hamal CDD
Attn: Jeffrey Herman

Phone: 561-681-9502
Fax: 561-683-1949

Project Hamilton Bay Security Lighting

Location: West Palm Beach, FL.

Date of Plans: Attached Spec Sheet
Pages:

Architect: N/A
Addenda: None

We submit the following to you to perform electrical work as shown in the following scope of work and specifications:

SCOPE OF WORK INCLUDES:

1. Supply and install (8) 16 feet above grade fiberglass light poles. (See the attached Spec Sheets)
2. Supply and install (8) Maximum 3 lamp Coach Style Light heads.(See the attached Spec Sheet)
3. Provide Directional Boring from island to island for the conduit and feeders.
4. Furnish and install one Time Clock for control of the Light fixtures.
5. Permits, engineering, inspections.

EXCLUDES:

- Survey or engineering fees
- FPL fees
- Replacement of sod or landscaping.
- Damage to any existing underground utilities not identified and located.
- Additional work that may be required by authority having jurisdiction.

TOTAL AMOUNT THIS CONTRACT,..... \$29,839.00

TWENTY NINE THOUSAND, EIGHT HUNDRED AND THIRTY NINE DOLLARS.

Static Electric Company

2

Payment terms:

25% down payment



50% upon delivery of poles and fixtures

15% upon substantial completion of electrical

10% upon final completion and inspections.

Contract terms:

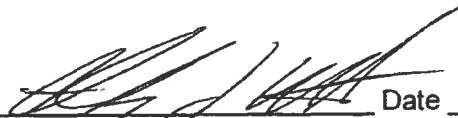
- Pole and Fixture submittals must be approved prior to releasing materials.
- Allow 6-8 weeks for delivery of poles and fixtures following executed contract, permit, deposit and approved submittals.

 Date 12/2/09  Date 12/15/09
Anthony J. Maturo, President
Static Electric Company
Name: ^{Sign} Steven Pincus
HAMEL CDD ^{Print} as Vice Chairman

Contract may be withdrawn if not executed within 30 days.

Product Specifications



1007BK - Westlake Cast 3-Light Outdoor Pole/Post Lantern



Item: 1007BK
 Collection: Westlake
 Finish: Black
 Glass:

Fixture Dimensions	
Width: 13.0"	Height: 28.0"
Length:	Extension:
HCO:	Back Plate: x
Chain:	Wire: 0'
Bulbs	
Quantity: 3	Type: CA
Wattage: 60w Max	Included: No
Install:	
Certifications/Qualifications	
Energy Star: No	
Other	
UPC: 783209100716	
Note:	

Westlake Cast is a transitional style, energy saving collection from Maxim Lighting International in Black, Empire Bronze, Pewter, Rust Patina or White finish.

Shipping Information									
Individual	Weight	Length	Width	Height	Case	Weight	Length	Width	Height
Qty: 1	5.8 lbs		13.0"	28.0"	Qty: 2	25.0 lbs	24.6"	14.2"	20.7"

CourtesyMax, StarGland and Vivax are trademarks of Maxim Lighting International, Inc. Maxim Lighting is a registered trademark of Maxim Lighting International, Inc. All designs, logos, products and images © 2009 Maxim Lighting International, Inc. All Rights Reserved.

Maxim Lighting reserves the right, at any time, to make changes in the design and/or construction of the product including the discontinuation of product without prior notice. Products are subject to revision in design and/or construction to conform to changes in UL/ETL/CSA standards, or that which may be required by law or availability of material.

All products are UL, ETL and/or CSA approved.

Color may vary from what is pictured above due to limitations inherent to photographic processes.

Always consult a qualified, licensed electrician before installation of any product weighing 35 pounds or more. We recommend that a qualified, licensed electrician do the installation. Always install to a mechanically sound structure.

Initial to indicate approval

ROUND TAPERED POLES



D **ROUND TAPERED POLES - COLOR SELECTION**

Cat No.	Description
BLK	Black
MTB	Matte Black
DBZ	Dark Bronze
DGR	Dark Green
HTG	Hunter Green
SLV	Silver
WHT	White
GRY	Grey
CC	Custom color - Please provide a minimum 3" x 3" color chip.
RAL	Please provide a four digit RAL color number.

E **ROUND TAPERED POLES - FINISH SELECTION**

Cat No.	Description
TXT	Natural texture of the reinforcing strands
SMS	Smooth surface finish

H **CRITICAL POINTS FOR ROUND TAPERED POLES**

Cat No.	Description
DTC	Top pole cap and drilling for a side mounted arm(s). Provide a template or drawing for the mounting pole locations and wireway.
FLD	Top pole cap. Field drill pole to accept arm(s).
R1	Single receptacle and housing with top cap cover. Molded in dark grey color. Standard location is 12" (305mm) below the top of the pole.
RC	Receptacle housing and a NEC listed (UL listed or ENEC receptacle) by others. Standard location is 12" (305mm) below the top of the pole.
RBC	XTREME™ urethane composite cap for use in direct embedded (DE) installations. Standard with ground strap - B configuration. Painted to match the pole color.

Diameter at Base =
 pole top diameter +
 (above ground height x .14"/ft.)
 example: 3.4" + (20 x .14) =
 3.4 + 2.8 = 6.2"



Initial to indicate approval

RT34

10'/3M to 30'/9M mounting heights

11

- Pole top diameter is 3.4"/86mm, .14 inch per foot taper
- Direct embedded option for lower installation cost
- Anchor base with one piece base cover
- Decorative XTREME™ base covers available

Ordering Information

SAMPLE CATALOG NUMBER LOGIC

	B	C	D	E	F	G	H
RT34	16	DE	DGR	SMS	27	-30	
RT34	20	AB	BLK	TXT	40	-35	RC
POLE	ABOVE GRADE HEIGHT	INSTALLATION METHOD	COLOR	SURFACE FINISH	TENON O.D.	TENON HEIGHT	OPTIONS

B Pole Height Above Ground

Cat No.	Description	WT	Wind Loading Data						
			WIND SPEED (MPH) WITH 3 SECOND GUST FACTOR						
			90	100	110	120	130	140	150
10	10 feet/3.10M	29	7.4	5.7	4.5	3.6	3.0	2.5	2.2
11	11 feet/3.35M	31	7.4	5.7	4.4	3.6	3.0	2.5	2.1
12	12 feet/3.65M	32	7.4	5.5	4.2	3.4	2.8	2.4	2.1
13	13 feet/3.96M	34	7.3	5.4	4.1	3.3	2.8	2.3	2.0
14	14 feet/4.27M	39	7.2	5.4	4.1	3.3	2.8	2.3	1.9
15	15 feet/4.57M	43	7.0	5.2	4.0	3.3	2.7	2.2	1.9
16	16 feet/4.88M	46	6.4	4.7	3.6	2.9	2.4	2.0	1.6
17	17 feet/5.18M	48	6.2	4.5	3.5	2.8	2.3	1.9	1.6
18	18 feet/5.49M	51	6.1	4.4	3.4	2.7	2.2	1.8	1.5
19	19 feet/5.79M	55	5.9	4.2	3.3	2.6	2.1	1.7	1.4
20	20 feet/6.10M	58	5.7	4.1	3.2	2.5	2.0	1.6	1.3
21	21 feet/6.40M	61	5.5	3.9	3.1	2.4	1.9	1.5	1.2
22	22 feet/6.71M	65	5.3	3.8	2.9	2.3	1.8	1.4	1.2
23	23 feet/7.01M	69	5.1	3.7	2.8	2.2	1.7	1.4	1.1
24	24 feet/7.32M	73	4.6	3.3	2.5	1.9	1.5	1.2	
25	25 feet/7.62M	76	4.4	3.2	2.4	1.9	1.4	1.1	
28	28 feet/8.53M	80	4.1	3.1	2.3	1.7	1.3	1.0	
27	27 feet/8.32M	90	4.0	2.9	2.2	1.6	1.2		
28	28 feet/8.53M	93	3.8	2.8	2.0	1.5	1.1		
29	29 feet/8.84M	96	3.7	2.6	1.9	1.4	1.0		
30	25 feet/9.14M	100	3.7	2.5	1.8	1.3			

* Weights listed are with anchor bases. Deduct twenty (20) pounds for direct embedded poles.

Wind speed values are for a 3 second gust per ASCE 7-98 and AASHTO 2001. Calculated per ASCE 7-98, 50-year recurrence interval, 1.0 Importance factor. Assumes load 12 inches above the pole top. Safety factor = 2.0

C INSTALLATION METHOD

Cat No.	Description
DE	Direct Embedded
	Below grade depth
	10 to 13 feet 3ft/.91M
	14 to 24 feet 4ft/1.2M
	25 to 30 feet 5ft/1.5M

Embedment depth may vary with local soil and wind conditions.

AB Anchor Base

D COLORS REFER TO PAGE 10

E SURFACE FINISH REFER TO

F TENON O.D. REFER TO PAGE 10

Cat No.	Description
23	2 3/8" (60mm)
27	2 7/8" (73mm)
30	3" (76mm)
35	3 1/2" (89mm)
40	4" (102mm)

G TENON HEIGHT

Cat No.	Description
-30	3.0" (76mm)
-35	3.5" (89mm)
-40	4.0" (102mm)
-50	5.0" (127mm)
-60	6.0" (152mm)

* For other tenon sizes contact the factory



COMPOSITE POLES

Initial to indicate approval

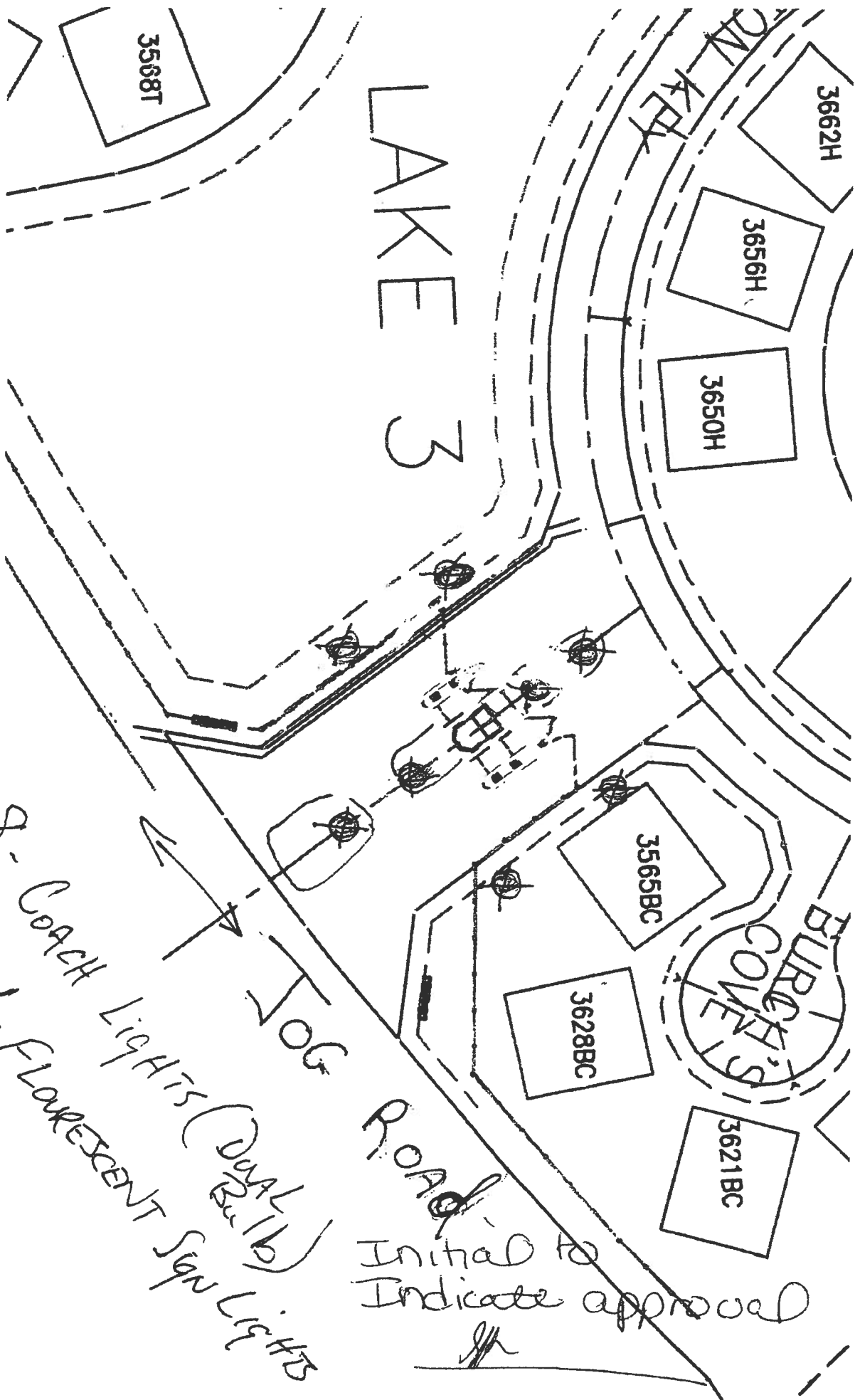

To Luis Hernandez at Governmentle Management,

I Anthony Janeiro reside at 6697 Traveler rd. in the Tides of Briar Bay. I am writing this letter about the electric panel that has been placed on the lake bank of my backyard. I am very upset about the location of this panel. I have two young kids that play in our yard and will be around the electric panel when they play. I am also upset because it is in view of the lake which could reflect resale value. When I purchased my house I picked this lot due to the fact that there was no transformers or utility boxes. I am disappointed that a letter was never sent out before this was done. Hopefully you can understand my situation. If I need to be contacted my number is (561) 640-3302.

Thank you
Anthony Janeiro

Hamal
Community Development District

Check Register Summary

10/1/2009 - 12/31/2009

Check Date	Check #'s	Total Amount
10/1/2009	1178-1184	\$ 10,130.73
10/5/2009	1185-1188	\$ 26,675.95
10/28/2009	1189-1192	\$ 5,594.85
11/2/2009	1193-1194	\$ 79,195.50
11/17/2009	1195-1202	\$ 59,182.45
12/8/2009	1203-1207	\$ 77,348.08
12/16/2009	1208-1211	\$ 11,005.82
12/17/2009	1212	\$ 642,875.77
Total		\$ 912,009.15

*** CHECK DATES 10/01/2009 - 12/31/2009 *** HAMAL CDD - GENERAL FUND BANK A HAMAL CDD - GENERAL

CHECK DATE	VEND#	INVOICE DATE	EXPENSED TO YRMO	SUB DPT ACCT#	SUBCLASS	VENDOR NAME	STATUS	AMOUNT	CHECK AMOUNT	CHECK #
10/01/09	00036	10/01/09	51010	200910	320-53800-46800	OCT-09 LAKE MGMT SVCS.	*	1,800.00	1,800.00	001178
10/01/09	00077	9/08/09	WPB12536	200909	320-53800-46200	ALLSTATE RESOURCE MGMT., INC.	*	150.00	150.00	
10/01/09	00013	9/08/09	93230819	200909	310-51300-42000	IRRIGATION REPAIRS	*	13.01	150.00	001179
10/01/09	00016	9/11/09	AUG-09	200908	320-53800-43000	DELIVERIES THRU 9/8/09	*	1,622.36	13.01	001180
10/01/09	00055	9/01/09	50	200908	310-51300-34000	FEDEX	*	3,166.67	1,622.36	
10/01/09	00055	9/01/09	50	200908	310-51300-34000	FLORIDA POWER & LIGHT COMPANY	*	3,166.67	1,622.36	001181
10/01/09	00055	9/01/09	50	200908	310-51300-35100	SEPT-09 MGMT FEES	*	41.67	3,166.67	
10/01/09	00055	9/01/09	50	200908	310-51300-40000	SEPT-09 COMPUTER TIME	*	200.00	41.67	
10/01/09	00055	9/01/09	50	200908	310-51300-40000	SEPT-09 RENT	*	.45	200.00	
10/01/09	00055	9/01/09	50	200908	310-51300-42000	SEPT-09 OFFICE SUPPLIES	*	3.08	.45	
10/01/09	00055	9/01/09	50	200908	310-51300-42500	SEPT-09 POSTAGE	*	27.45	3.08	
10/01/09	00002	8/31/09	47143	200907	310-51300-31500	SEPT-09 COPIES	*	463.00	27.45	
10/01/09	00002	8/31/09	47144	200907	310-51300-31500	GOVERNMENTAL MANAGEMENT SERVICES	*	2,477.92	463.00	001182
10/01/09	00003	9/01/09	4608645	200909	310-51300-48000	JULY 09 - GENERAL COUNSEL	*	165.12	2,477.92	
10/05/09	00077	9/01/09	WPB12525	200909	320-53800-46200	HOPPING GREEN & SAMS	*	1,967.00	165.12	001183
10/05/09	00087	9/14/09	4042	200910	310-51300-45000	NOTICE OF MTNG DTS 9/1/09	*	5,000.00	1,967.00	
10/05/09	00087	9/14/09	4042	200910	310-51300-45000	PALM BEACH NEWSPAPERS, INC	*	1,967.00	5,000.00	001184
10/05/09	00087	9/14/09	4042	200910	310-51300-45000	INSTALL 4 MAHOGONY TREES	*	1,967.00	1,967.00	
10/05/09	00087	9/14/09	4042	200910	310-51300-45000	CLINTAR	*	1,967.00	1,967.00	001185
10/05/09	00087	9/14/09	4042	200910	310-51300-45000	FY2010 LIAB INSURANCE	*	5,000.00	1,967.00	
10/05/09	00087	9/14/09	4042	200910	310-51300-45000	EGIS INSURANCE ADVISORS, LLC	*	5,000.00	5,000.00	001186

HAM - HAMAL-- MPHILLIPS

*** CHECK DATES 10/01/2009 - 12/31/2009 ***
 HAMAL CDD - GENERAL FUND
 BANK A HAMAL CDD - GENERAL

CHECK DATE	VEND#	INVOICE DATE	YRMO	DFT	ACCT#	SUB	SUBCLASS	VENDOR NAME	STATUS	AMOUNT	CHECK#	AMOUNT
10/05/09	00077	10/01/09	09	09	WPB12584	200910	320-53800-46200	OCT 09 - LANDSCAPE MAINT	*	12,969.00		
10/05/09		10/05/09	09	09	WPB12552	200909	320-53800-46500	LANDSCAPE ENHANCEMENT 10/5	*	3,222.00		
								CLINTAR				16,191.00 001187
10/05/09	00055	10/01/09	09	09	200910	310-51300-34000		OCT-09 MGMT FEES	*	3,261.67		
10/01/09	51	200910	310-51300-35100					OCT-09 COMPUTER TIME	*	41.67		
10/01/09	51	200910	310-51300-44000					OCT-09 RENT	*	200.00		
10/01/09	51	200910	310-51300-51000					OCT-09 OFFICE SUPPLIES	*	.30		
10/01/09	51	200910	310-51300-42000					OCT-09 POSTAGE	*	11.76		
10/01/09	51	200910	310-51300-42500					OCT-09 COPIES	*	2.55		
								GOVERNMENTAL MANAGEMENT SERVICES				3,517.95 001188
10/28/09	00036	11/01/09	09	09	200910	300-15500-10000		NOV-09 LAKE MGMT SRVCS	*	1,800.00		
10/28/09	00077	10/12/09	09	09	WPB12626	200910	320-53800-46300	IRRIGATION REPAIR 10/2/09	*	2,090.00		
								CLINTAR				2,090.00 001190
10/28/09	00025	10/01/09	09	09	21693	200910	310-51300-54000	FY10 ANNUAL DISTRICT FEE	*	175.00		
10/28/09	00016	10/12/09	09	09	200909	320-53800-43000		SEPT-09 SERVICES	*	1,529.85		
								DEPARTMENT OF COMMUNITY AFFAIRS				175.00 001191
								FLORIDA POWER & LIGHT COMPANY				1,529.85 001192
11/02/09	00084	10/21/09	09	09	200910	320-53800-49000		DEP ON FOUNTAIN DESIGN	*	58,250.00		
								FOUNTAIN DESIGN GROUP, INC.				58,250.00 001193
11/02/09	00085	10/21/09	09	09	200910	320-53800-49000		DEP - SEC LAKE 1	*	2,348.75		
								DEP - SEC LAKE 2	*	2,941.25		
								DEP - SEC LAKE 4	*	2,180.00		

HAM - HAMAL-- MPHILLIPS

*** CHECK DATES 10/01/2009 - 12/31/2009 *** HAMAL CDD - GENERAL FUND BANK A HAMAL CDD - GENERAL

CHECK DATE	VEND#	INVOICE DATE	INVOICE YRMO	DPT ACCT#	SUB	SUBCLASS	VENDOR NAME	STATUS	AMOUNTCHECK..... AMOUNT	#
10/21/09		DEPOSITS	200910	320-53800	-49000		STATIC ELECTRIC COMPANY	*	2,737.50		
		DEP - SEC LAKE 6									
10/21/09		DEPOSITS	200910	320-53800	-49000		FISHERIES MGMT SERV GRASS	*	3,753.75		
		DEP - SEC LAKE 7									
10/21/09		DEPOSITS	200910	320-53800	-49000		FISHERIES MGMT SERV -BASS	*	2,745.00		
		DEP - SEC LAKE 8									
10/21/09		DEPOSITS	200910	320-53800	-49000		DEC-09 LAKE MGMT SERV.	*	4,239.25		
		DEP - SEC LAKE 9									
11/17/09	00036						ALLSTATE RESOURCE MGMT., INC.	*	7,300.00	001195	
11/17/09	00077	7/31/09	WPB12343	200907	320-53800	-46300	IRRIGATION REPAIRS 7/28	*	719.38		
10/22/09		WPB12637	200910	320-53800	-46200		LANDSCAPE ENHANCEM 10/15	*	5,934.00		
10/28/09		WPB12661	200910	320-53800	-46200		LANDSCAPE ENHANCEM 10/26	*	1,967.00		
10/31/09		WPB12670	200910	320-53800	-46300		IRRIGATION REPAIRS 10/28	*	793.00		
11/01/09		WPB12701	200911	320-53800	-46200		NOV-09 LANDSCAPE MAINT.	*	12,969.00		
11/12/09		WPB12762	200911	320-53800	-46500		LANDSCAPE ENHANCEM 11/9	*	18,880.00		
11/17/09	00013	11/03/09	93859579	200911	310-51300	-42000	SERVICE THRU 11/3/09	*	26.10		
11/10/09		93937755	200911	310-51300	-42000		SERVICE THRU 11/10/09	*	19.50		
11/17/09	00058	10/22/09	9980247	200909	310-51300	-49000	UNEMPLOYMENT TAX 3RD QTR	*	4.03		
11/17/09	00016	11/10/09	OCT-09	200910	320-53800	-43000	OCT-09 SERVICES	*	1,219.28		
							FLORIDA UC FUND			4.03	001198
							FLORIDA POWER & LIGHT COMPANY				
							HAM - HAMAL-- MPELLIPS				

CHECK DATE	VEND#	INVOICE DATE	YRMO	DPT	ACCT#	SUB	SUBCLASS	VENDOR NAME	STATUS	AMOUNTCHECK..... AMOUNT #
11/17/09	00055	11/02/09	52	200911	310-51300-34000			NOV-09 MGMT FEES	*	3,261.67	
11/02/09	52	200911	310-51300-35100					NOV-09 COMPUTER TIME	*	41.67	
11/02/09	52	200911	310-51300-44000					NOV-09 RENT	*	200.00	
11/02/09	52	200911	310-51300-35100					NOV-09 ADJ COMPUTER CHARG	*	41.67	
11/02/09	52	200911	310-51300-51000					NOV-09 OFFICE SUPPLIES	*	2.95	
11/02/09	52	200911	310-51300-42000					NOV-09 POSTAGE	*	3.96	
11/02/09	52	200911	310-51300-42500					NOV-09 COPIES	*	127.50	
GOVERNMENTAL MANAGEMENT SERVICES -											
11/17/09	00028	11/17/09	111709	200911	300-20700-10100			TXFER OF TAX RCPTS 11/17	*	5,297.08	
HAMAL CDD C/O US BANK											
11/17/09	00002	10/30/09	48375	200909	310-51300-31500			GENERAL COUNSEL 9/30/09	*	458.00	
HOPPING GREEN & SAMS											
12/08/09	00077	11/16/09	WPB12768	200911	320-53800-46200			11/16 WEED SPRAY APPLICAT	*	1,823.00	
11/19/09	WPB12779	200911	320-53800-46200					11/19 INSTALL ROYAL PALM	*	275.00	
11/23/09	WPB12785	200911	320-53800-46300					11/17 IRRIGATION REPAIR	*	139.50	
12/01/09	WPB12847	200912	320-53800-46200					12/1 LANDSCAPE MAINT.	*	12,969.00	
CLINTAR											
12/08/09	00055	11/17/09	53	200911	310-51300-41000			10/5-11/5 CONFERENCE CALL	*	12.98	
12/01/09	54	200912	310-51300-34000					DEC-09 MGMT FEES	*	3,261.67	
12/01/09	54	200912	310-51300-35100					DEC-09 COMPUTER TIME	*	41.67	
12/01/09	54	200912	310-51300-44000					DEC-09 RENT	*	200.00	
12/01/09	54	200912	310-51300-51000					DEC-09 OFFICE SUPPLIES	*	6.43	
12/01/09	54	200912	310-51300-42000					DEC-09 POSTAGE	*	18.00	
HAM - HAMAL-- MPHILLIPS											

3,596.08 001200
 5,297.08 001201
 458.00 001202
 15,206.50 001203

*** CHECK DATES 10/01/2009 - 12/31/2009 ***
 HAML CDD - GENERAL FUND
 BANK A HAML CDD - GENERAL

CHECK DATE	VEND#	INVOICE DATE	YRMO	DEP	ACCT#	SUB	SUBCLASS	VENDOR NAME	STATUS	AMOUNTCHECK..... AMOUNT
12/01/09	54	200912	310	51300	42500				*	77.80	
		DEC-09	COPIES								
12/08/09	00020	11/13/09	5427	200911	310	51300	31200	GOVERNMENTAL MANAGEMENT SERVICES		1,250.00	3,618.55 001204
		S06A	4/30/09	ARBITRAGE	RP				*		
12/08/09	00028	12/08/09	120809	200912	300	20700	10100	GRAU & ASSOCIATES	*	56,925.42	1,250.00 001205
		12/8	TXFER TAX	RCPTS							
12/08/09	00002	11/25/09	48868	200910	310	51300	31500	HAML CDD C/O US BANK	*	347.61	56,925.42 001206
		10/31	GENERAL	COUNSEL							
12/16/09	00036	1/01/10	54256	201001	320	53800	46800	HOPPING GREEN & SAMS	*	1,800.00	347.61 001207
		JAN-10	LAKE	MGMT	SERVICE						
12/16/09	00077	12/10/09	WPB12905	200912	320	53800	46300	ALLSTATE RESOURCE MGMT., INC.	*	430.00	1,800.00 001208
		12/3	IRRIGATION	REPAIRS							
12/16/09	00016	12/11/09	NOV-09	200911	320	53800	43000	CLINTAR	*	1,316.07	430.00 001209
		NOV-09	SERVICES								
12/16/09	00085	12/02/09	SEC LIGH	200912	320	53800	49000	FLORIDA POWER & LIGHT COMPANY	*	7,459.75	1,316.07 001210
		SEC	LIGHTING	25% DEP							
12/17/09	00028	12/17/09	121709	200912	300	20700	10100	STATIC ELECTRIC COMPANY	*	642,875.77	7,459.75 001211
		TXFER	TAX	RCPTS	12/17						
								HAML CDD C/O US BANK			642,875.77 001212

TOTAL FOR BANK A 912,009.15
 TOTAL FOR REGISTER 912,009.15

HAM - HAML-- MPHILLIPS

Hamal
COMMUNITY DEVELOPMENT DISTRICT
COMBINED BALANCE SHEET

December 31, 2009

	Governmental Fund Types			Account Groups		Totals (Memorandum Only) 2010
	General	Debt Service	Capital Projects	Fixed Assets	General Long-Term Debt	
ASSETS:						
Cash	\$446,208	---	---	---	---	\$446,208
Investments:						
State Board Revenue - Series 2006	\$550,780	---	---	---	---	\$550,780
Construction - Series 2006	---	\$897,645	---	---	---	\$897,645
Due from General Fund	---	---	\$2,080	---	---	\$2,080
Due from Debt Service	---	\$20,023	---	---	---	\$20,023
Amount Available	\$5,021	---	---	---	---	\$5,021
Amount to be Provided	---	---	---	---	\$917,668	\$917,668
Improvements	---	---	---	\$4,344,949	\$10,222,332	\$10,222,332
						\$4,344,949
TOTAL ASSETS	\$1,002,009	\$917,668	\$2,080	\$4,344,949	\$11,140,000	\$17,406,705
LIABILITIES:						
Accounts Payable	\$912	---	---	---	---	\$912
Due to General Fund	---	\$1,250	---	---	---	\$1,250
Due to Debt Service	\$20,023	---	---	---	---	\$20,023
Bonds Payable	---	---	---	---	\$11,140,000	\$11,140,000
FUND BALANCES:						
Investment in General Fixed Assets	---	---	---	\$4,344,949	---	\$4,344,949
Reserved for General Fund	\$284,650	---	---	---	---	\$284,650
Reserved for Debt Service	---	\$916,418	---	---	---	\$916,418
Reserved for Capital Projects	---	---	\$2,080	---	---	\$2,080
Unreserved	\$696,423	---	---	---	---	\$696,423
TOTAL LIABILITIES & FUND EQUITY & OTHER CREDITS	\$1,002,009	\$917,668	\$2,080	\$4,344,949	\$11,140,000	\$17,406,705

*Reflects Principal payments through May 1, 2009

Hamal

COMMUNITY DEVELOPMENT DISTRICT

GENERAL FUND

Statement of Revenues & Expenditures

For The Period Ending December 31, 2009

	ADOPTED BUDGET	PRORATED BUDGET THRU 12/31/09	ACTUAL THRU 12/31/09	VARIANCE
REVENUES:				
Maintenance Assessments	\$495,372	\$431,993	\$431,993	\$0
Fair Share Agreement	\$45,400	\$0	\$0	\$0
Interest Income	\$4,500	\$1,125	\$492	(\$633)
TOTAL REVENUES	\$545,272	\$433,118	\$432,485	(\$633)
EXPENDITURES:				
ADMINISTRATIVE:				
Supervisors Fees/FICA Taxes	\$8,612	\$2,153	\$861	\$1,292
Engineering	\$15,000	\$3,750	\$0	\$3,750
Assessment Roll	\$300	\$75	\$0	\$75
Attorney	\$20,000	\$5,000	\$348	\$4,652
Annual Audit	\$7,500	\$1,875	\$0	\$1,875
Management Fees	\$39,140	\$9,785	\$9,785	(\$0)
Computer Time	\$500	\$125	\$83	\$42
Telephone	\$150	\$38	\$13	\$25
Postage	\$1,000	\$250	\$103	\$147
Printing & Binding	\$1,200	\$300	\$208	\$92
Rentals & Leases	\$2,400	\$600	\$600	\$0
Insurance	\$6,500	\$6,500	\$5,000	\$1,500
Legal Advertising	\$3,000	\$750	\$0	\$750
Other Current Charges	\$1,000	\$250	\$226	\$24
Office Supplies	\$225	\$56	\$10	\$47
Dues, Licenses, Subscriptions	\$175	\$175	\$175	\$0
Capital Outlay	\$250	\$63	\$0	\$63
TOTAL ADMINISTRATIVE	\$106,952	\$31,744	\$17,412	\$14,332
MAINTENANCE				
Stormwater Pump Station	\$17,500	\$4,375	\$0	\$4,375
Utilities	\$20,000	\$5,000	\$2,535	\$2,465
Landscape Maintenance	\$159,283	\$39,821	\$67,786	(\$27,965)
Landscape Materials	\$95,000	\$23,750	\$0	\$23,750
Irrigation System	\$25,000	\$6,250	\$3,979	\$2,271
Fountain Maintenance	\$6,000	\$1,500	\$0	\$1,500
Lakes	\$36,600	\$9,150	\$5,400	\$3,750
Contingencies	\$100,000	\$25,000	\$94,318	(\$69,318)
TOTAL MAINTENANCE	\$459,383	\$114,846	\$174,018	(\$59,172)
RESERVES				
Sound Barriers	\$30,000	\$7,500	\$0	\$7,500
Stormwater Pump Station	\$18,000	\$4,500	\$0	\$4,500
1st Quarter Operating	\$120,625	\$30,156	\$0	\$30,156
TOTAL RESERVES	\$168,625	\$42,156	\$0	\$42,156
TOTAL EXPENDITURES	\$734,960	\$188,746	\$191,430	(\$34,032)
EXCESS REVENUES (EXPENDITURES)	(\$189,688)		\$241,055	
FUND BALANCE - Beginning	\$278,324		\$740,018	
FUND BALANCE - Ending	<u>\$88,636</u>		<u>\$981,073</u>	

Hamal
COMMUNITY DEVELOPMENT DISTRICT

DEBT SERVICE FUND
Statement of Revenues & Expenditures
For The Period Ending December 31, 2009

	ADOPTED BUDGET	PRORATED THRU 12/31/09	ACTUAL THRU 12/31/09	VARIANCE
REVENUES:				
Interest Income	\$7,500	\$1,875	\$88	(\$1,787)
Assessments	\$825,432	\$719,825	\$719,825	\$0
TOTAL REVENUES	\$832,932	\$721,700	\$719,912	(\$1,787)
EXPENDITURES:				
Interest Expense - 11/1	\$264,907	\$264,907	\$265,775	(\$868)
Interest Expense - 05/1	\$300,000	\$0	\$0	\$0
Principal Expense - 05/01	\$264,907	\$0	\$0	\$0
Other Debt Service Costs	\$11,000	\$1,250	\$1,250	\$0
TOTAL EXPENDITURES	\$840,814	\$266,157	\$267,025	(\$868)
EXCESS REVENUES (EXPENDITURES)	(\$7,882)		\$452,888	
FUND BALANCE - Beginning	\$391,924		\$463,530	
FUND BALANCE - Ending	\$384,042		\$916,418	

Hamal
COMMUNITY DEVELOPMENT DISTRICT
CAPITAL PROJECTS FUND
Statement of Revenues & Expenditures
For The Period Ending December 31, 2009

	ADOPTED BUDGET	PRORATED THRU 12/31/09	ACTUAL THRU 12/31/09	VARIANCE
REVENUES:				
Interest Income	\$0	\$0	\$1	\$1
TOTAL REVENUES	\$0	\$0	\$1	\$1
EXPENDITURES:				
Capital Outlay	\$0	\$0	\$0	\$0
Cost of Issuance	\$0	\$0	\$0	\$0
TOTAL EXPENDITURES	\$0	\$0	\$0	\$0
EXCESS REVENUES (EXPENDITURES)	\$0		\$1	
FUND BALANCE - Beginning			\$2,079	
FUND BALANCE - Ending			<u>\$2,080</u>	

Hamal

Community Development District Tax Collections

For the year ending September 30, 2010

Date Received	Gross Tax Received	Discounts/ Penalties	Commissions	Interest	Net Amount Received	Debt Service Fund 62.49%	General Fund 37.51%	Total 100.00%
11/8/2009	\$ 41,236.84	\$ 1,860.77	\$ 393.76	\$ -	\$ 38,982.31	\$ 24,361.86	\$ 14,620.45	\$ 38,982.31
11/19/2009	\$ 54,825.50	\$ 2,193.03	\$ 526.32	\$ -	\$ 52,106.15	\$ 32,563.56	\$ 19,542.59	\$ 52,106.15
12/10/2009	\$ 1,082,287.43	\$ 43,207.48	\$ 10,390.80	\$ -	\$ 1,028,689.15	\$ 642,875.77	\$ 385,813.38	\$ 1,028,689.15
12/21/2009	\$ 33,554.87	\$ 1,190.98	\$ 323.64	\$ -	\$ 32,040.25	\$ 20,023.44	\$ 12,016.81	\$ 32,040.25
1/8/2010	\$ 249.75	\$ -	\$ -	\$ -	\$ 249.75	\$ 156.08	\$ 93.67	\$ 249.75
TOTALS	\$ 1,212,154.39	\$ 48,452.26	\$ 11,634.52	\$ -	\$ 1,152,067.61	\$ 719,980.71	\$ 432,086.90	\$ 1,152,067.61

87.22%

To Debt Service V#28 001.300.20700.10100

Check #

12/8/2009	\$ 56,925.42	1206
12/17/2009	\$ 642,875.77	1212
1/11/2010	\$ 20,023.44	1216
1/14/2010	\$ 156.08	1220

Balance to Transfer \$ 719,980.71

\$ 0.00